

Best New Homes. Best Neighborhoods. Best Prices.

Hampshire S.W. ROANOKE COUNTY
~~\$ 374,950~~ \$359,950



Authentic Arts & Crafts Cottage ~ American Classic Stone Columned Front Porch ~ 5 Bedrooms, 2.5 Baths ~ Beautiful Master Suite ~ "Her" Closet is HUGE! ~ Cave Spring Schools ~ Beautiful and Natural Setting ~ Views.

DIRECTIONS: From RT 419 take RT 221(Brambleton Avenue) South. Left on Cotton Hill Road. Right on Monet Drive at Hampshire Sign. Home on right.

Hampshire S.W. ROANOKE COUNTY
~~\$ 374,950~~ \$359,950



ENERGY STAR HOME 25% ENERGY SAVINGS
 4 BRs, 2.5 BAs - GREAT "New" Floor Plan - Huge level backyard that backs up to Wooded Area - Windowed Walls in Family Room and Breakfast Area - Have views of mountains and wooded area - Features items: 9' ceiling on first floor, hardwood floor In Family Room, Kit and Breakfast Area, Granite Counter tops. **MUST SEE HOME!**

DIRECTIONS: From Rt 419 take RT 221 (Brambleton Ave) South. Left on Cotton Hill Road. Right on Monet Drive at Hampshire Sign. Home on left.

Court Homes SOUTH ROANOKE
~~\$ 552,950~~ \$469,950



ORIGINAL PRICE \$552,950 ~ REDUCED \$83,000!
 Beautiful Furnished Model ~ 3 Bedrooms, 2.5 Baths
 Luxurious One Floor Living
 with Inviting Master Suite and Kitchen
NEVER SHOVEL SNOW, CUT GRASS OR RAKE LEAVES AGAIN!
Directions: On Franklin Rd. turn at Red Lobster onto Duke of Gloucester St., go uphill through the Southwood entrance gate. Left on Somercroft Court, Right on Northshire Court. Model is on right.

Court Homes SOUTH ROANOKE
~~\$ 546,950~~ \$469,950



ORIGINAL PRICE \$546,950 ~ REDUCED \$77,000!
 Ready for Your Finishes! Choose Your Own Colors and Cabinets! One Floor Living - Exclusive Gated Community - Huge Master Suite - Upper Level offers 2 Large Bedrooms, Bath and Loft - Perfect for Grand Kids
Directions: On Franklin Rd. turn at Red Lobster onto Duke of Gloucester St., go uphill through the Southwood entrance gate. Left on Somercroft Court, Right on Northshire Court. Home on right next to Model.



BRAND NEW HOME IN BEAUTIFUL COUNTRY SETTING
 Convenient SW County/Salem location. 5 mins. to LewisGale. Hidden Valley Schools. Stream in Backyard! Surrounding Trees and Mountains Protected by Conservation Easement! Large, Flat Backyard ~ 4 BR, 2.5 BA ~ Granite Countertops ~ Ready for New School Year
\$309,950

Directions: 3045 Franklin Street. From Route 419 to Keagy Road across from Lewis Gale into Fairway Forest, left on Hidden Valley DR, Right on Fairway Estates DR, Right on Hidden Woods DR, Right on Fairway Ridge Road, Right on Franklin Street, .5 miles on left.

The Groves S.W. ROANOKE COUNTY
 Last New Home! \$289,950



4 Bedrooms, 2.5 BA, Master Suite with Cathedral Ceiling, Authentic Stone Arts & Crafts Architecture, Community Playground, Blue Ridge Parkway Next Door. The Groves - Roanoke's most popular new home community!
DIRECTIONS: From RT 419 take RT 221(Brambleton Avenue) South. Take Left on Cotton Hill Road. Turn Left on Monet Drive. House on left just past Westshire Ct.

For More Information
 Alexander Boone
 540-278-1365

ABoone@BooneHomes.net

BooneHomes.net



2 Wooded Tracts For Sale

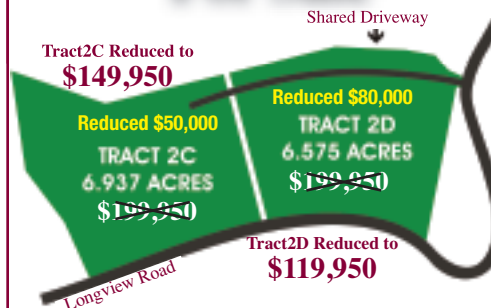

Directions: From Rt. 419, Go South on Rt.221, Right on Roselawn Rd., Go 2 miles and take Left on Longview Road, Lots are on the left side.



S.W. COUNTY ACREAGE

6.5 Acres - \$119,950 • 6.9 Acres - \$149,950
 Public Water & Sewer • Hidden Valley Schools
 One of a Kind Location • Wooded and Private

Directions: From Rt. 419, Go South on Rt.221, Right on Roselawn Rd., Go 2 miles and take Left on Longview Road, Lots are on the left side.